

FSB-KM

STIHL



2 - 17 Instruction Manual



Contents

1	KombiSystem.....	2
2	Guide to Using this Manual.....	2
3	Safety Precautions and Working Techniques.....	2
4	Approved KombiEngines.....	6
5	Approved Combinations of Cutting Attachment, Deflector, Handle and Harness.....	7
6	Mounting the KombiTool.....	7
7	Mounting the Deflector.....	8
8	Mounting the Cutting Attachment.....	9
9	Fitting the Harness.....	11
10	Starting / Stopping the Engine.....	12
11	Storing the Machine.....	13
12	Maintaining the Mowing Head.....	13
13	Maintenance and Care.....	14
14	Minimize Wear and Avoid Damage.....	14
15	Main Parts.....	15
16	Specifications.....	15
17	Maintenance and Repairs.....	15
18	Disposal.....	16
19	EC Declaration of Conformity.....	16
20	UKCA Declaration of Conformity.....	16
21	Addresses.....	17

1 KombiSystem

In the STIHL KombiSystem a number of different KombiEngines and KombiTools can be combined to produce a power tool. In this instruction manual the functional unit formed by the KombiEngine **and** KombiTool is referred to as the power tool.

Therefore, the separate instruction manuals for the KombiEngine and KombiTool should be used together for the power tool.

Always read and and make sure you understand **both** instruction manuals before using your power tool for the first time and keep them in a safe place for future reference.

2 Guide to Using this Manual

2.1 Pictograms

All the pictograms attached to the machine are shown and explained in this manual.

2.2 Symbols in text

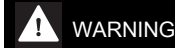

WARNING

Warning where there is a risk of an accident or personal injury or serious damage to property.

NOTICE

Caution where there is a risk of damaging the machine or its individual components.

2.3 Engineering improvements

STIHL's philosophy is to continually improve all of its products. For this reason we may modify the design, engineering and appearance of our products periodically.

Therefore, some changes, modifications and improvements may not be covered in this manual.

3 Safety Precautions and Working Techniques



Some special safety precautions must be observed to reduce the risk of personal injury when operating this power tool because of the very high speed of its cutting attachment.



Both user manuals (KombiEngine and KombiTool) must be read through attentively before using the unit for the first time and kept in a safe place for future reference. Non-compliance with the user manuals may cause serious or even fatal injury.

The machine should only be provided or loaned to people familiar with this model and its operation. The KombiEngine and KombiTool user manuals should always be handed over with the machine.

Depending on the cutting attachment fitted, use your trimmer only for cutting grass, undergrowth and similar materials.

The machine must not be used for any other purposes – **risk of accidents!**

Only use cutting attachments and accessories that are explicitly approved for this power tool model by STIHL or are technically identical. If you have any questions in this respect, consult your dealer.

Use only high-quality parts and accessories. In order to avoid the risk of accidents and damage to the machine.

STIHL recommends the use of genuine STIHL tools and accessories. They are specifically designed to match the product and meet your performance requirements.

The guard provided with your machine may not protect the operator from all foreign objects (gravel, glass, wire etc.) ejected by the revolving cutting attachment. Ejected objects may also ricochet and strike the operator.

Never attempt to modify your power tool in any way since this may increase the risk of personal injury. STIHL excludes all liability for personal injury and damage to property caused while using unauthorized attachments.

Do not use a high-pressure washer to clean the power tool. The solid jet of water may damage parts of the unit.

3.1 Clothing and equipment

Wear proper protective clothing and equipment.



Clothing must be robust but allow complete freedom of movement. Wear close-fitting clothes such as a boiler suit, not a loose jacket.

Do not wear clothing which could become trapped in wood, brush or moving parts of the machine. Do not wear a scarf, necktie or jewelry. Tie up and confine long hair above your shoulders.



Wear sturdy shoes with non-slip soles.



WARNING



To reduce the risk of eye injuries, wear close-fitting safety glasses in accordance with European Standard EN 166. Make sure the safety glasses are a snug fit.

Wear face protection and make sure it is a good fit. Face protection alone is not sufficient to protect the eyes.

Wear "personal" sound protection, e.g. ear defenders.



Wear sturdy protective gloves made of a resistant material (e. g. leather).

STIHL can supply a comprehensive range of personal protective equipment.

3.2 Transporting the machine

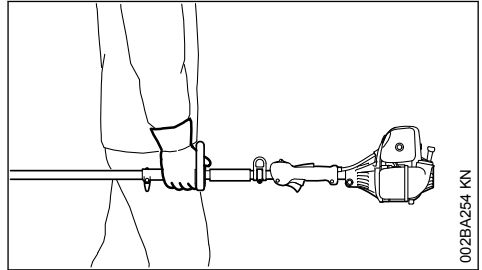

Always stop the engine.

Carry the unit properly balanced by the shaft or loop handle.

By vehicle: When transporting in a vehicle, properly secure your machine to prevent tipping over, damage and fuel spillage.

3.3 Before starting

Check that your power tool is properly assembled and in good condition – refer to appropriate chapters in the KombiEngine and KombiTool user manuals:

- Use only an approved combination of cutting attachment, deflector, handle and harness. All parts must be assembled properly and securely
- Check cutting attachment for correct and secure assembly and good condition
- Check safety devices (e. g., deflector for cutting attachments) for damage and/or wear. Always replace damaged parts. Never operate the unit with a damaged deflector
- Never attempt to modify the controls or safety devices.
- Keep the handles dry and clean – free from oil and dirt – this is important for safe control of the machine
- Adjust harness and handle to suit your height and reach. Observe the chapter "Fitting the Harness"

To reduce the risk of personal injury, do not operate your power tool if it is damaged or not properly assembled!

To prepare for emergencies when using a harness: Practice setting down the machine quickly. To avoid damage, do not throw the machine to the ground when practicing.

See also notes on "Before Starting" in the user manual of the KombiEngine you are using.

3.4 Holding and guiding the machine

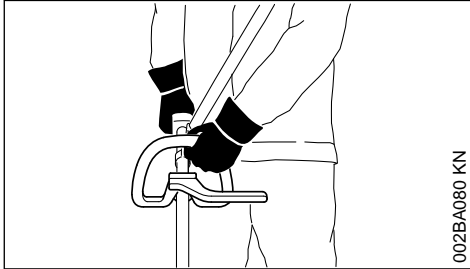

Always hold the unit firmly with both hands on the handles.

On units with a loop handle and barrier bar, left hand on loop handle, right hand on control handle, even if you are left-handed.

Make sure you always have a firm and secure footing.

3.5 While working

In the event of impending danger or in an emergency, switch off the engine immediately by moving the slide control / stop switch/button to **0** or **STOP**.

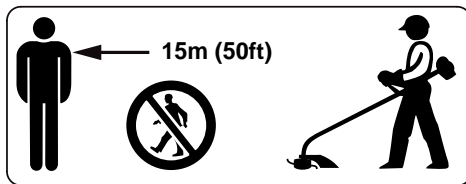

There is a risk of accident from ejected objects within a wide area around the working space, so you must ensure that there is no-one within a 15 m radius of the machine. This distance must also be maintained in relation to objects (vehicles, window panes) – **risk of property damage!** Even at distances beyond 15 m, the danger cannot be ruled out.

Check that the engine is properly idling so that the cutting tool will not continue rotating after you release the throttle trigger. Check and correct the idle speed setting at regular intervals. If the attachment still rotates when the engine is idling, have your dealer check your machine and make

proper adjustments or repairs – see KombiEngine user manual.

Take special care in **slippery conditions** – damp, snow, ice, on slopes or uneven ground!

Watch out for obstacles: tree stumps, roots – **risk of tripping or stumbling!**

Make sure you always have a firm and secure footing.

Never operate your power tool with one hand.

Be particularly alert and cautious when wearing hearing protection because your ability to hear warnings (shouts, alarms, etc.) is restricted.

Take breaks when you start getting tired or feeling fatigue – **risk of accidents!**

Work calmly and carefully – in daylight conditions and only when visibility is good. Proceed with caution, do not put others in danger.

If your power tool is subjected to unusually high loads for which it was not designed (e.g. heavy impact or a fall), always check that it is in good condition before continuing work – see also "Before Starting". Make sure the safety devices are working properly. Never use a power tool that is no longer safe to operate. In case of doubt, contact a dealer.



Deflector may be used with mowing heads. Do not use metal cutting attachments – **risk of injury**.



To reduce the risk of injury from thrown objects, never operate the unit without the proper deflector for the type of cutting attachment being used.



Check the work site – rocks, metal objects etc. could get caught up and ejected – potentially beyond a distance of 15 m – **risk of injury!** Such objects can also damage the cutting attachment and other property (e.g. parked vehicles, windows).



Be particularly careful when working on difficult, densely grown terrain.

When cutting tall scrub, under bushes and hedges: Keep cutting attachment at a minimum height of 15 cm to avoid harming small animals.

Examine the cutting attachment periodically at short intervals and as soon as you note any noticeable changes:

- Turn off the engine, hold the device securely, press the cutting attachment against the ground to stop it

- Check condition and secure fitting; watch out for cracks
- Immediately replace defective cutting tools, also in the event of minor hairline cracks

Clean grass and plant residue off the cutting attachment mounting at regular intervals – remove any accumulated material from the cutting attachment and deflector.

To reduce the risk of injury, shut off the engine before replacing the cutting attachment.

After finishing work or before leaving the power tool unattended: Shut off the engine.

Never continue using or attempt to repair damaged or cracked cutting attachments.

Particles or pieces may come off and hit the operator or a bystander at a high speed – **risk of very severe injuries!**

If a rotating cutting attachment touches a rock or another hard object, sparks may be generated which may possibly ignite combustible materials. Also dried-out plants and brushwood are combustible, above all in hot and dry weather. If there is a risk of fire, do not use cutting attachments in the vicinity of combustible materials, dried-out plants or brushwood. It is mandatory that you ask the responsible forestry office about current fire hazards.

Only use a deflector with a properly fitted blade, which limits the mowing line to the permissible length.

For manually adjustable mowing heads, always switch off the engine before adjusting the mowing line – **risk of injury!**

Misuse with mowing lines that are too long reduces the working speed of the engine. The constant slipping of the clutch can cause overheating and damage to important components (e.g. clutch, plastic housing parts) – e.g. due to the cutting attachment rotating during idling – **risk of injury!**

3.6 Maintenance and Repairs

Service the machine regularly. Do not attempt any maintenance or repair work not described in the KombiTool and KombiEngine instruction manuals. Have all other work performed by a servicing dealer.

STIHL recommends that you have servicing and repair work carried out exclusively by an authorized STIHL servicing dealer. STIHL dealers are regularly given the opportunity to attend training

courses and are supplied with the necessary technical information.

Only use high-quality replacement parts in order to avoid the risk of accidents and damage to the machine. If you have any questions in this respect, consult a servicing dealer.

STIHL recommends the use of genuine STIHL replacement parts. They are specifically designed to match your model and meet your performance requirements.

To reduce the risk of injury, **always shut off the engine** before carrying out any maintenance or repairs or cleaning the machine.

3.7 Symbols on Deflectors

Some of the following symbols are applied to the outside of the deflector to indicate the approved combination of cutting attachment and deflector.



This symbol indicates the direction of rotation of the cutting attachment.

max Ø XXX

This icon shows the maximum diameter of the cutting attachment in millimeters.



This symbol shows the rated speed of the cutting attachment.

3.8 Shoulder strap

The power tool may be used without a shoulder strap. Shoulder strap and carrying ring are special accessories.

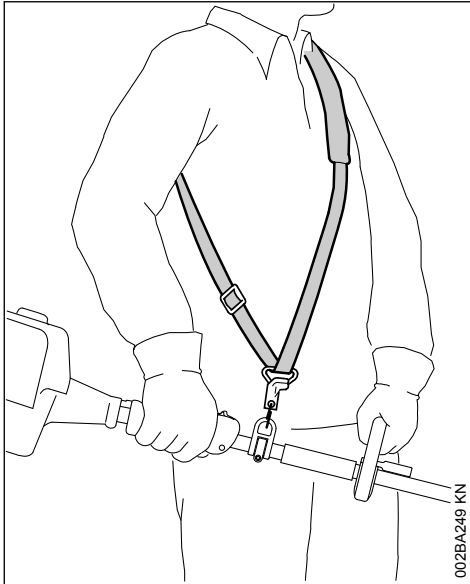

002BA249 KN

- ▶ With the engine running, attach the machine to the shoulder strap.

3.9 Mowing Head with Nylon Lines

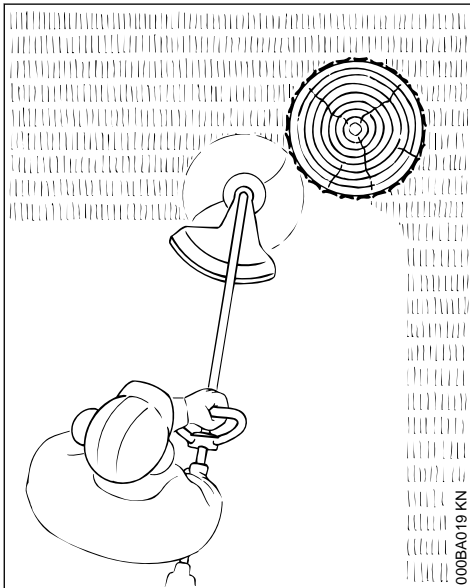

000BA019 KN

Nylon line achieves a soft cut for edging and trimming around fence posts, trees, etc. – less risk of damaging tree bark.

! WARNING

To reduce the **risk of injury**, **never** use steel wire in place of the nylon cutting line.

3.10 STIHL Polycut Mowing Head with Plastic Blades

For mowing unobstructed edges of meadows (without posts, fences, trees or similar obstacles).

Make sure to pay attention to the safety warnings, maintenance information and wear marks in the User Manual of the mowing head.

! WARNING

If the wear limit marks are ignored, there is a risk of the cutting tool shattering and flying parts injuring the operator or bystanders.

To reduce the risk of accidents from shattered blades, avoid contact with stones, metal and similar solid objects.

Check PolyCut blades for cracks at regular intervals. If a crack is found in one of the blades, always replace **all** the blades.

4 Approved KombiEngines

4.1 KombiEngines

Only use KombiEngines supplied or explicitly approved by STIHL for use with the attachment.

Depending on the cutting attachment used, always observe the chapter "Permissible combinations of cutting attachment, deflector, grip and harness".

This KombiTool may be operated only in combination with the following KombiEngines:

STIHL KM 56 R, KM 85 R¹⁾, KM 94 R, KM 235.0 R

¹⁾ Only outside EU

4.2 Brushcutters with split shaft

The KombiTool can also be fitted to STIHL brushcutters with a split shaft (T-models) (basic power tools).

This KombiTool can therefore also be used on the following machine:

STIHL FR 235.0 T

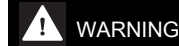

WARNING

Refer to the User Manual of the power tool for use of the barrier bar.

5 Approved Combinations of Cutting Attachment, Deflector, Handle and Harness

Cutting attachment

Deflector

Handle

Carrying strap

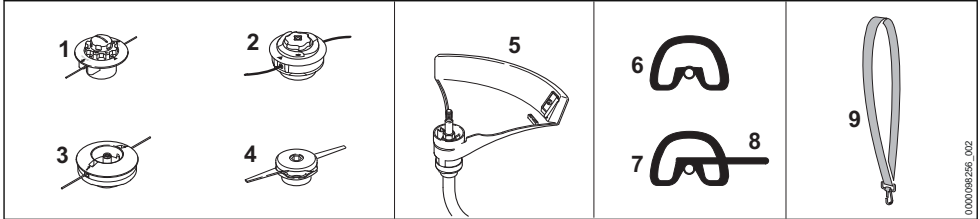

5.1 Permissible combinations

Choose the correct combination from the table depending on the cutting tool!

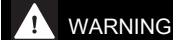

WARNING

For safety reasons, no other combinations are permitted – risk of accidents!

5.2 Cutting attachments

5.2.1 Mowing heads

- 1 STIHL AutoCut 5-2
- 2 STIHL AutoCut C 6-2
- 3 STIHL DuroCut 5-2
- 4 STIHL PolyCut 6-2

5.3 Deflector

- 5 Guard with blade for mowing heads

5.4 Handle

- 6 Loop handle
- 7 Loop handle with
- 8 Barrier bar

5.5 Carrying strap

- 9 Shoulder strap can be used

6 Mounting the KombiTool

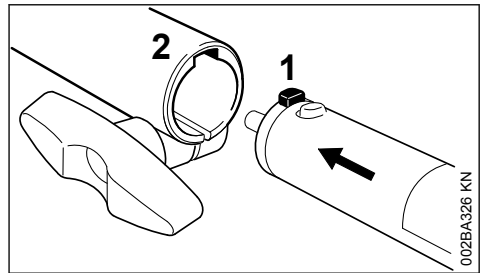

- ▶ Push the lug (1) on the drive tube into the slot (2) in the coupling sleeve as far as stop.

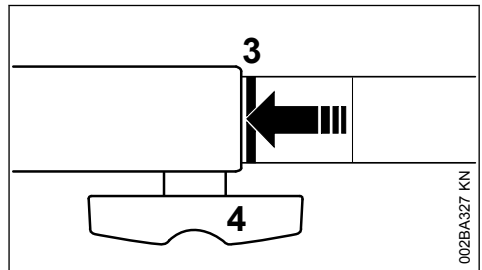

When correctly installed, the red line (3) (arrow point) must be flush with the end of the coupling sleeve.

- ▶ Tighten down the star knob (4) firmly.

6.1 Removing the KombiTool

- ▶ Reverse the above sequence to remove the drive tube.

7 Mounting the Deflector

7.1 Fitting the line limiter blade

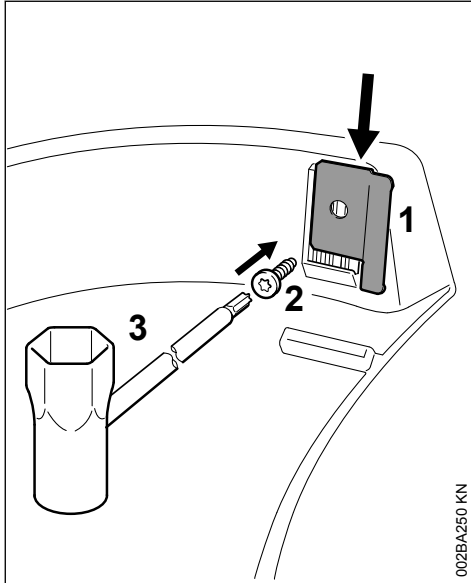

002BA250 KN

- ▶ Slide the blade (1) into the deflector's guide.
- ▶ Insert and tighten down the screw (2) with the combination wrench (3) – supplied with KombiEngine or available as special accessory.

7.2 Mounting the deflector

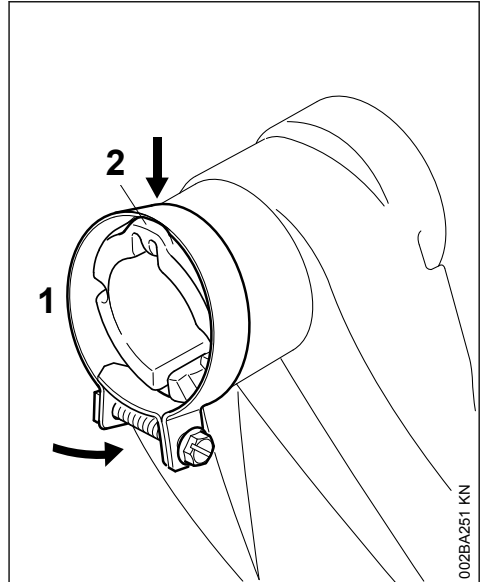

002BA251 KN

- ▶ Push the clamp (1) over the lug (2) on the deflector and hold it there.
- ▶ Push the other side of the clamp (1) over the deflector.

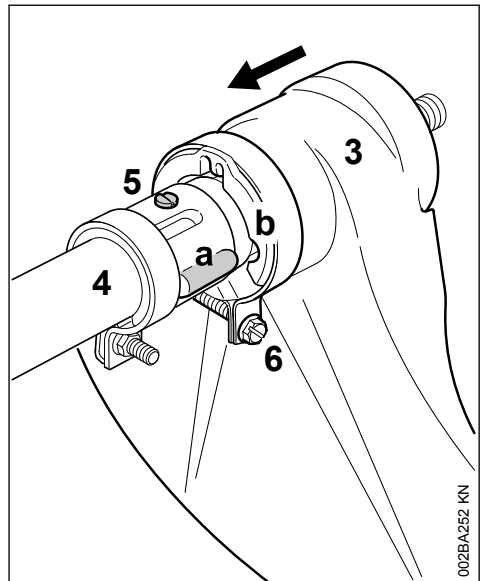

002BA252 KN

- ▶ Slide the deflector (3) onto the drive tube (4) so that the bead (a) on the drive tube engages the guide (b) in the deflector.

- ▶ Push the deflector (3) into position until the set screw (5) engages.
- ▶ Tighten down the clamp screw (6) firmly.

8 Mounting the Cutting Attachment

8.1 Placing power tool on the ground

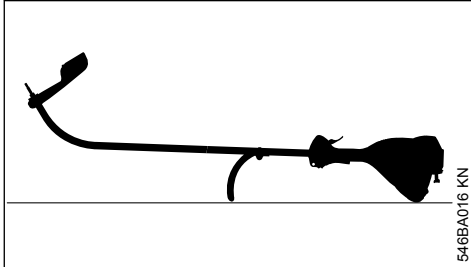

- ▶ Switch off the engine.
- ▶ Lay your trimmer on its back with the loop handle and shroud pointing down and the output shaft facing up.

8.2 Thrust Plate

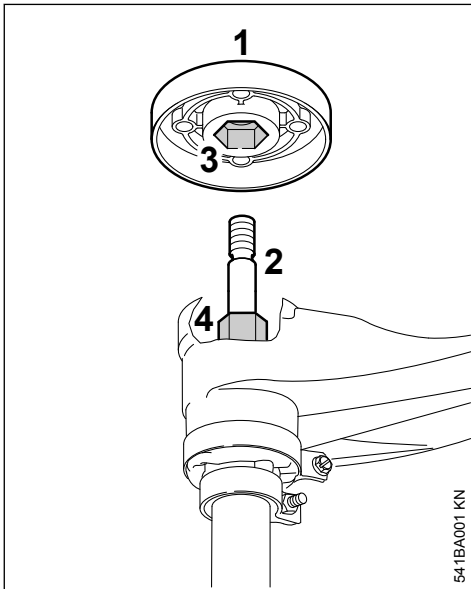

The thrust plate is supplied with the DuroCut 5-2 and is only required for this mowing head.

Mowing head STIHL AutoCut 5-2, mowing head STIHL AutoCut C 6-2. STIHL PolyCut 6-2 mowing head

- ▶ Remove thrust plate (1), if present, from shaft (2)

STIHL DuroCut 5-2 mowing head

- ▶ Push the thrust plate (1) onto the shaft (2) by inserting the internal hexagon (3) onto the hexagon (4)

8.3 Retaining the Shaft

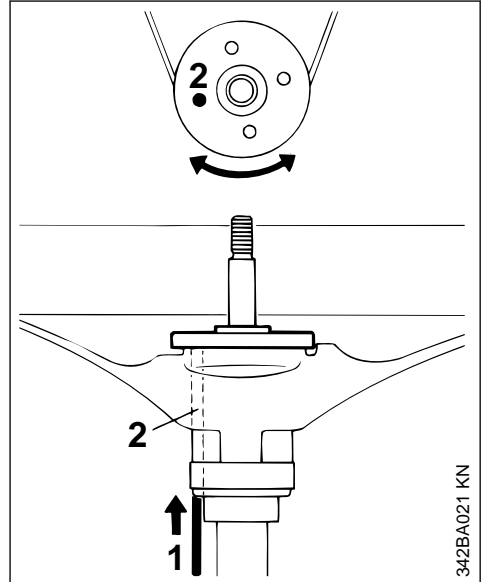

- ▶ To block the shaft, insert a suitable tool (1) through the holes (2) in the deflector and thrust plate – turn the thrust plate back and forth if necessary

8.4 STIHL AutoCut 5-2

Keep the supplement sheet for the mowing head in a safe place!

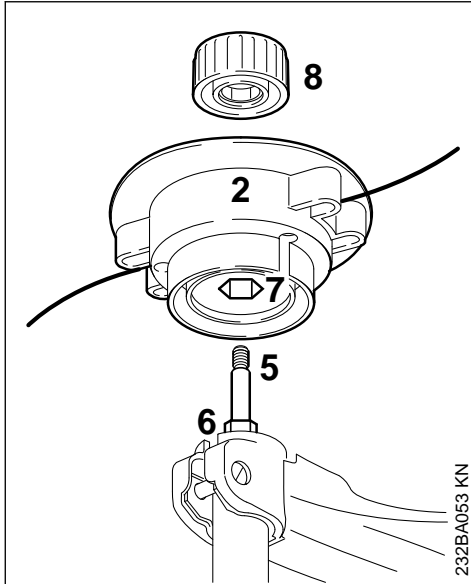

232BA053 KN

- ▶ Push the upper part (2) onto the shaft (5) while inserting the internal hexagon (7) onto the hexagon (6)
- ▶ Place the cap (8) on the upper part
- ▶ Hold the upper part (2) with your hand
- ▶ Turn the cap (8) clockwise and tighten it firmly by hand

8.4.1 Removing the Mowing Head

- ▶ Hold the mowing head with your hand
- ▶ Turn the cap counterclockwise until it can be removed
- ▶ Remove the mowing head.

8.5 STIHL AutoCut C 6-2 and STIHL PolyCut 6-2

Keep the supplement sheet for the mowing head in a safe place!

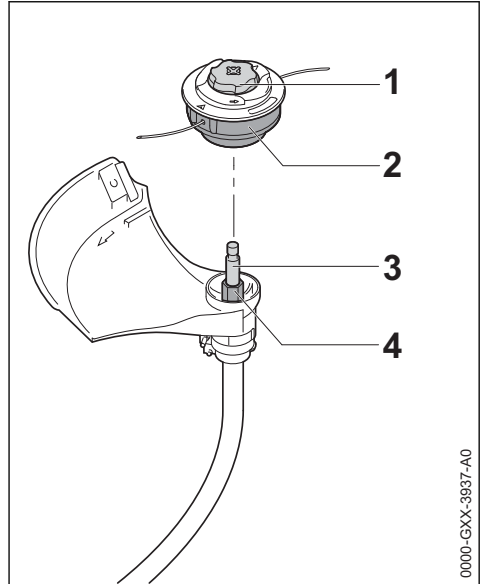

0000-GXX-3937-A0

- ▶ Place the mowing head (2) on the shaft (3) while inserting the internal hexagon (2) on the hexagon (4)
- ▶ Hold the mowing head (2) with your hand.
- ▶ Turn cap (1) clockwise and tighten it firmly by hand.

8.5.1 Removing the Mowing Head

- ▶ Hold the mowing head with your hand
- ▶ Turn the cap counterclockwise until the mowing head can be removed
- ▶ Remove the mowing head.

8.6 STIHL DuroCut 5-2

Keep the supplement sheet for the mowing head in a safe place!

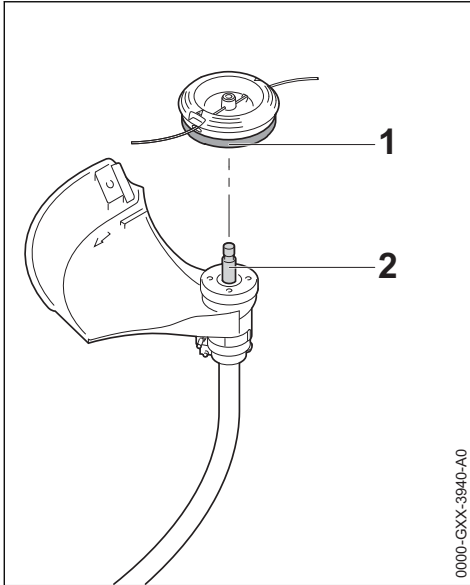

0000-GXX-3940-A0

- ▶ Screw the mowing head (1) clockwise on to the shaft (2) as far as it will go
- ▶ Block the shaft, see "Blocking the shaft"
- ▶ Tighten down the mowing head (1) firmly

NOTICE

Remove the tool that was used to block the shaft.

8.6.1 Removing the Mowing Head

- ▶ Block the shaft, see "Blocking the shaft"
- ▶ Turn the mowing head counterclockwise

9 Fitting the Harness

The type and style of the harness, carrying ring and carabiner (spring hook) depend on the market.

The use of the harness is described in the chapter on "Approved Combinations of Cutting Attachment, Deflector, Handle and Harness".

9.1 Shoulder strap

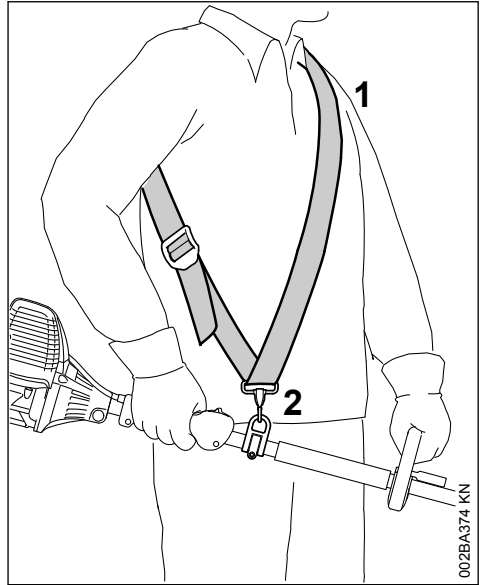

002BA374 KN

- ▶ Put on the shoulder strap (1).
- ▶ Adjust the length of the strap so that the carabiner (2) is about a hand's width below your right hip.

9.2 Attaching Machine to Harness

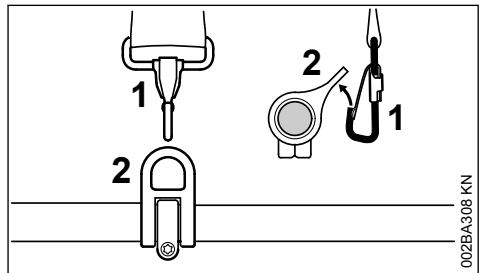

002BA308 KN

- ▶ Attach the carabiner (1) to the carrying ring (2) on the drive tube – hold the carrying ring steady.

9.3 Detaching Machine from Harness

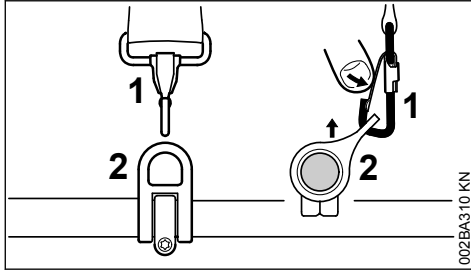

- ▶ Press down the bar on the carabiner (1) and pull the carrying ring (2) out of the carabiner.

9.4 Throwing Off the Machine

WARNING

The machine must be quickly thrown off in the event of imminent danger. Practice removing and putting down the power tool as you would in an emergency. To avoid damage, do not throw the power tool to the ground when practicing.

Practice quickly detaching the power tool from the carabiner as described under "Detaching Machine from Harness".

Practice slipping the strap off your shoulder.

10 Starting / Stopping the Engine

10.1 Starting the Engine

Always follow the operating instructions for the KombiEngine and basic power tool.

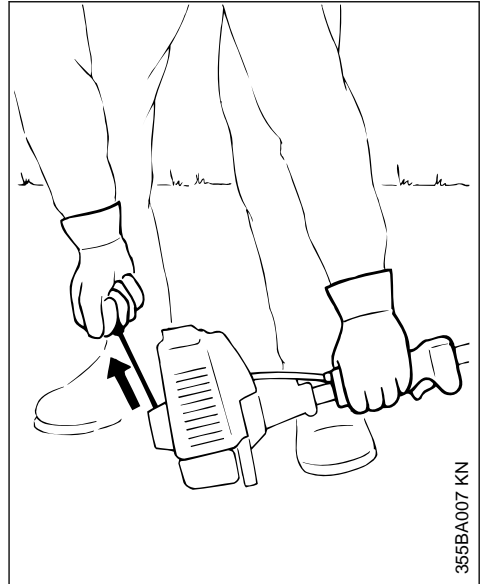

- ▶ Place the machine on the ground – it must rest securely on the machine support and the gear-box.

To reduce the risk of accidents, check that the cutting attachment is not touching the ground or any other obstacles.

- ▶ Make sure you have a firm footing, either standing, stooping or kneeling.
- ▶ Hold the machine with your left hand and press it down **firmly** – do not touch the controls on the control handle – see KombiEngine or basic power tool instruction manual.

NOTICE

Do not stand or kneel on the drive tube.

WARNING

The cutting attachment may begin to move as soon as the engine starts. For this reason, blip the throttle after starting – the engine returns to idling speed.

The starting procedure is now as described in the instruction manual of the KombiEngine or basic power tool you are using.

10.2 Stopping the Engine

- ▶ See KombiEngine or basic power tool instruction manual.

11 Storing the Machine

If not used for approx. 30 days or longer

- ▶ Remove, clean and inspect the cutting attachment.
- ▶ If the KombiTool is removed from the KombiEngine and stored separately: Fit the protective cap on the shaft to avoid dirt getting into the coupling.
- ▶ Store the machine in a dry and secure location. Keep out of the reach of children and other unauthorized persons

12 Maintaining the Mowing Head

12.1 Placing power tool on the ground

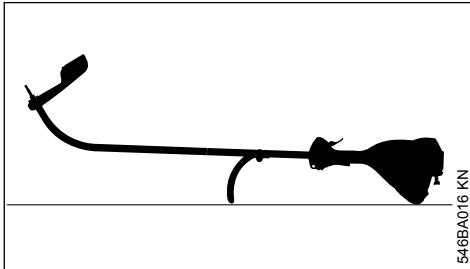

- ▶ Switch off the engine.
- ▶ Lay your trimmer on its back with the loop handle and shroud pointing down and the output shaft facing up.

12.2 Replacing Nylon Line

Always check the mowing head for signs of wear before replacing the nylon line.



WARNING

If there are signs of serious wear, replace the complete mowing head.

The nylon mowing line is referred to as "nylon line" or "line" in the following.

The mowing head is supplied with illustrated instructions for replacing the nylon line. Keep the instructions for the mowing head in a safe place.

- ▶ If necessary, remove the mowing head.

12.3 Adjusting Nylon Line

12.3.1 STIHL AutoCut

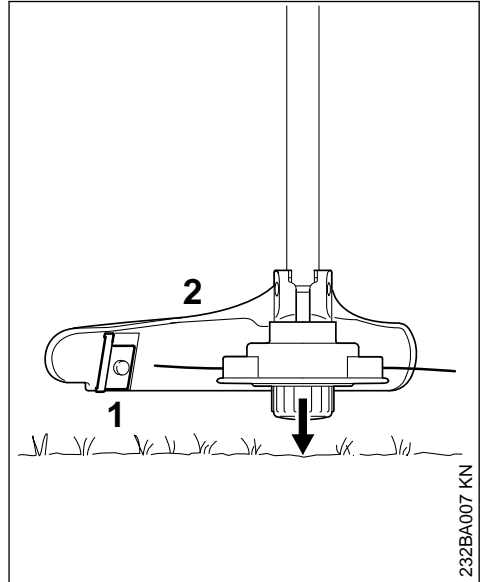

- ▶ Hold the rotating mowing head above the ground – tap it on the ground once – about 3 cm (1.2 in) of fresh line is advanced.
- ▶ The blade (1) on the deflector (2) trims surplus line to the correct length – avoid tapping the mowing head more than once at a time.

Line feed operates only if **both** lines still have a minimum length of **2.5 cm (1 in)**.

If the line is shorter than 2.5 cm (1 in):



WARNING

To reduce the risk of injury, always shut off the engine before adjusting the nylon mowing line by hand.

- ▶ Turn the machine over.
- ▶ Press down the cap on the spool as far as stop.
- ▶ Pull the ends of the lines out of the spool.

If the spool is empty, refill with nylon line.

12.3.2 All other mowing heads

Refer to the leaflet supplied with the mowing head.

 **WARNING**

To reduce the risk of injury, always shut off the engine before adjusting the nylon mowing line by hand.

12.4 Replacing Nylon Line

STIHL DuroCut

 **WARNING**

To reduce the risk of injury, always shut off the engine before refilling the mowing head.

- ▶ Fit nylon line in the mowing head as described in the instructions supplied.

12.5 Replacing Cutting Blades

12.5.1 STIHL PolyCut

Always check the mowing head for signs of wear before installing new cutting blades.

 **WARNING**

If there are signs of serious wear, replace the complete mowing head.

The thermoplastic cutting blades are referred to as "blades" in the following.

The mowing head is supplied with illustrated instructions for replacing the blades. Keep the instructions for the mowing head in a safe place.

 **WARNING**

To reduce the risk of injury, always shut off the engine before installing the blades.

- ▶ Remove the mowing head.
- ▶ Replace blades as shown in the illustrated instructions.
- ▶ Mount the mowing head on the machine.

13 Maintenance and Care

The following intervals apply to normal operating conditions only. If your daily working time is longer or operating conditions are difficult (very dusty work area, etc.), shorten the specified intervals accordingly.

All accessible screws and nuts

- ▶ Retighten if necessary

Cutting attachments

- ▶ Check condition, check tightness before starting work and after every fueling stop

- ▶ Replace if damaged

Safety labels

- ▶ Replace illegible safety labels

14 Minimize Wear and Avoid Damage

Observing the instructions in this manual and the KombiEngine manual helps reduce the risk of unnecessary wear and damage to the power tool.

The power tool must be operated, maintained and stored with the due care and attention described in these instruction manuals.

The user is responsible for all damage caused by non-observance of the safety precautions, operating and maintenance instructions. This includes in particular:

- Alterations or modifications to the product not approved by STIHL.
- Using tools or accessories which are neither approved or suitable for the product or are of a poor quality.
- Using the product for purposes for which it was not designed.
- Using the product for sports or competitive events.
- Consequential damage caused by continuing to use the product with defective components.

14.1 Maintenance Work

All the operations described in the chapter on "Maintenance and Care" must be performed on a regular basis. If these maintenance operations cannot be performed by the owner, they should be performed by a servicing dealer.

STIHL recommends that you have servicing and repair work carried out exclusively by an authorized STIHL servicing dealer. STIHL dealers are regularly given the opportunity to attend training courses and are supplied with the necessary technical information.

If these maintenance operations are not carried out as specified, the user assumes responsibility for any damage that may occur. Among other parts, this includes:

- Corrosion and other consequential damage resulting from improper storage.
- Damage to the product resulting from the use of poor quality replacement parts.

14.2 Parts Subject to Wear and Tear

Some parts of the power tool are subject to normal wear and tear even during regular operation in accordance with instructions and, depending on the type and duration of use, have to be replaced in good time. Among other parts, this includes:

- Cutting attachments (all types)
- Mounting hardware for cutting attachments
- Deflectors for cutting attachments

15 Main Parts

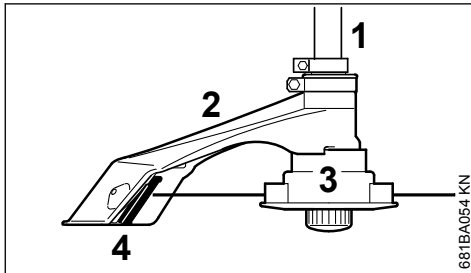

- 1 Drive tube
- 2 Deflector
- 3 Mowing head
- 4 Line limiting blade

16 Specifications

16.1 Engine speed

Max. output shaft speed on cutting attachment with KombiEngine:

KM 56 R:	10600 rpm
KM 85 R:	11000 rpm
KM 94 R:	10200 rpm
KM 235.0 R:	11100 rpm
FR 235.0 T:	11100 rpm

16.2 Weight

without cutting attachment and deflec-0.7 kg
tor:

16.3 Sound and vibration values

Noise and vibration data measurements on power tools with the FSB-KM KombiTool include idling and rated maximum speed with the same duration of exposure.

For further details on compliance with Vibration Directive 2002/44/EC, visit

www.stihl.com/vib

16.3.1 Sound pressure level L_{peq} in accordance with ISO 22868

with mowing head

KM 56 R with loop handle:	95 dB(A)
KM 85 R with loop handle:	96 dB(A)
KM 94 R with loop handle:	91 dB(A)
KM 235.0 R with loop handle:	98 dB(A)
FR 235.0 T:	99 dB(A)

16.3.2 Sound power level L_w in accordance with ISO 22868

with mowing head

KM 56 R with loop handle:	109 dB(A)
KM 85 R with loop handle:	112 dB(A)
KM 94 R with loop handle:	109 dB(A)

16.3.3 Sound power level $L_{w,eq}$ in accordance with ISO 22868

with mowing head

KM 235.0 R with loop handle:	110 dB(A)
FR 235.0 T:	110 dB(A)

16.3.4 Vibration level $a_{hv,eq}$ in accordance with ISO 22867

with mowing head	Handle, left	Handle, right
KM 56 R with loop handle:	6.7 m/s ²	7.0 m/s ²
KM 85 R with loop handle:	7.3 m/s ²	7.5 m/s ²
KM 94 R with loop handle:	7.2 m/s ²	6.4 m/s ²
KM 235.0 R with loop handle:	7.7 m/s ²	9.4 m/s ²
FR 235.0 T:	6.5 m/s ²	4.6 m/s ²

The K-factor in accordance with Directive 2006/42/EC is 2.0 dB(A) for the sound pressure level and sound power level; the K-factor in accordance with Directive 2006/42/EC is 2.0 m/s² for the vibration level.

16.4 REACH

REACH is an EC regulation and stands for the Registration, Evaluation, Authorization and Restriction of Chemical substances.

For information on compliance with the REACH regulation (EC) No. 1907/2006 see

www.stihl.com/reach

17 Maintenance and Repairs

Users of this machine may only carry out the maintenance and service work described in this user manual. All other repairs must be carried out by a servicing dealer.

STIHL recommends that you have servicing and repair work carried out exclusively by an author-

ized STIHL servicing dealer. STIHL dealers are regularly given the opportunity to attend training courses and are supplied with the necessary technical information.

When repairing the machine, only use replacement parts which have been approved by STIHL for this power tool or are technically identical. Only use high-quality replacement parts in order to avoid the risk of accidents and damage to the machine.

STIHL recommends the use of original STIHL replacement parts.

Original STIHL parts can be identified by the STIHL part number, the **STIHL** logo and the STIHL parts symbol  (the symbol may appear alone on small parts).

18 Disposal

Contact the local authorities or your STIHL servicing dealer for information on disposal.

Improper disposal can be harmful to health and pollute the environment.

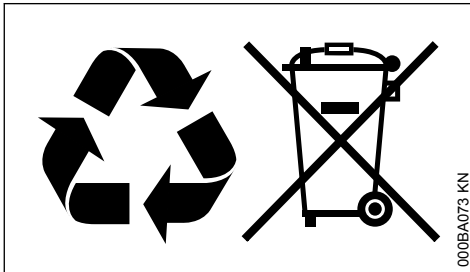

- ▶ Take STIHL products including packaging to a suitable collection point for recycling in accordance with local regulations.
- ▶ Do not dispose with domestic waste.

19 EC Declaration of Conformity

ANDREAS STIHL AG & Co. KG
Badstr. 115
D-71336 Waiblingen
Germany

declares under our sole responsibility that

Designation:	Scythe KombiTool
Make:	STIHL
Series:	FSB-KM
Serial identification number:	4137

conforms to the relevant provisions of Directives 2006/42/EC and 2000/14/EC and has been developed and manufactured in compliance with the following standards in the versions valid on the date of production:

EN ISO 12100, EN ISO 11806-1 (in conjunction with the specified KM models).

The measured and the guaranteed sound power level have been determined in accordance with Directive 2000/14/EC, Annex V, and standard ISO 10884.

Measured sound power level

with KM 56 R:	109 dB(A)
with KM 85 R:	112 dB(A)
with KM 94 R:	109 dB(A)
with KM 235.0 R:	113 dB(A)
with FR 235.0 T:	113 dB(A)

Guaranteed sound power level

with KM 56 R:	111 dB(A)
with KM 85 R:	114 dB(A)
with KM 94 R:	111 dB(A)
with KM 235.0 R:	115 dB(A)
with FR 235.0 T:	115 dB(A)

Technical documents deposited at:

ANDREAS STIHL AG & Co. KG
Produktzulassung

The year of manufacture is specified on the power tool.

Waiblingen, 2022-09-19

ANDREAS STIHL AG & Co. KG

pp



Robert Olma, Vice President, Regulatory Affairs & Global Governmental Relations

20 UKCA Declaration of Conformity

ANDREAS STIHL AG & Co. KG
Badstr. 115
D-71336 Waiblingen

Germany

declares under our sole responsibility that

Designation:	Scythe KombiTool
Make:	STIHL
Series:	FSB-KM

Serial identification number: 4137

conforms to the relevant provisions of the UK regulations Supply of Machinery (Safety) Regulations 2008 and Noise Emission in the Environment by Equipment for use Outdoors Regulations 2001 and has been manufactured in compliance with the following standards in the versions valid on the date of production:

EN ISO 12100, EN ISO 11806-1 (in conjunction with the specified KM models).

The measured and guaranteed sound power levels were determined in accordance with the UK regulation Noise Emission in the Environment by Equipment for Use Outdoors Regulations 2001, Schedule 8, using the ISO 10884 standard.

Measured sound power level

with KM 56 R:	109 dB(A)
with KM 85 R:	112 dB(A)
with KM 94 R:	109 dB(A)
with KM 235.0 R:	113 dB(A)
with FR 235.0 T:	113 dB(A)

Guaranteed sound power level

with KM 56 R:	111 dB(A)
with KM 85 R:	114 dB(A)
with KM 94 R:	111 dB(A)
with KM 235.0 R:	115 dB(A)
with FR 235.0 T:	115 dB(A)

Technical documents deposited at:

ANDREAS STIHL AG & Co. KG

The year of manufacture is indicated on the power tool.

Waiblingen, 2022-09-19

ANDREAS STIHL AG & Co. KG

pp



Robert Olma, Vice President, Regulatory Affairs & Global Governmental Relations

21 Addresses

www.stihl.com

www.stihl.com



0458-541-0121-D



0458-541-0121-D